



## **11 Springfield Green Springfield Shrewsbury Shropshire SY2 6LJ**

**£675 per calendar month**

**A spacious 3 bedroom end terrace house, convenient for good local amenities. Includes: Entrance Hall, Living Room, Kitchen/Dining Room, Conservatory, 3 Bedrooms, Shower Room, Separate WC, GCH, DG, Good Sized Rear Garden. Available Now. No Pets, Smokers or DSS**



11 Springfield Green, Springfield, Shrewsbury, Shropshire, SY2 6LJ

- Entrance Hall
- Living Room 12' 8" x 12' 6" (3.86m x 3.81m)
- Kitchen/Dining Room 18' 11" x 9' 3" (5.76m x 2.82m)
- Conservatory 9' 4" x 8' 4" (2.84m x 2.54m)
- Bedroom 1 12' 8" x 9' 9" (3.86m x 2.97m)
- Bedroom 2 11' 1" x 9' 3" (3.38m x 2.82m)
- Bedroom 3 8' 9" x 8' 11" (2.66m x 2.72m)
- Shower Room
- Separate WC

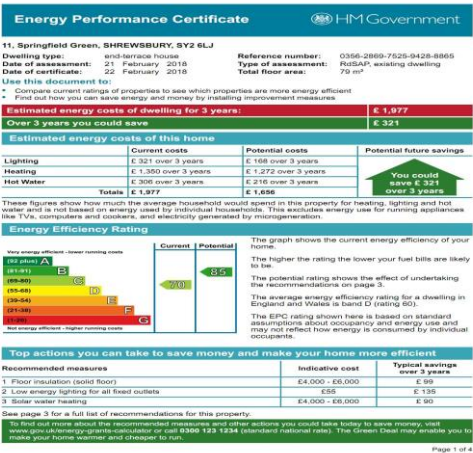

Ground Floor



First Floor

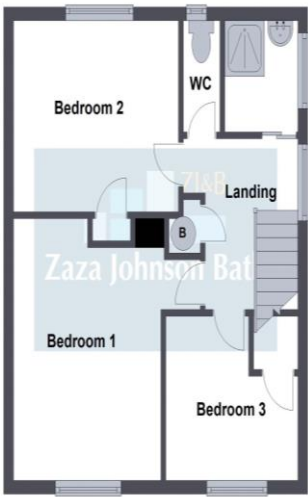

FLOOR PLANS FOR GUIDANCE ONLY

