

# haf jones & pegler

gwerthwyr tai • estate agents



Melin Coed Mill  
Glasinfryn, LL57 4UD

£40,000



[www.hafjonesandpegler.co.uk](http://www.hafjonesandpegler.co.uk)

317 High Street ■ Bangor ■ Gwynedd ■ LL57 1YA ■ 01248 364 422  
[sales@hafjonesandpegler.co.uk](mailto:sales@hafjonesandpegler.co.uk)



**A former mill which is now a ruin with only certain parts of the stone walls remaining. The land which is sloping to the river Cegin extends to 1.5 acre or thereabouts with a large number of mature trees. The building is hidden away a short distance from the highway in this rural locality. Development potential considered unlikely.**

### **Directions**

Proceeding out of Bangor along Llandegai Road (A5), continue straight ahead at the by-pass flyover roundabout and at the next roundabout, turn right onto the A4244 (signposted for Llanberis). After 0.9 of a mile, turn right (signposted for Glasinfryn) and follow this road for just over half a mile. proceed through the centre of the village passing the church on your left and on reaching the 'T' junction turn right under the flyover, pass the first cottage on your right and the entrance to the farm on your left, the drive to the property will then be seen on the right hand side with a 5 MPH sign, pass the large stone house on the right and follow the road round to the right, the drive to the mill will then be seen on the left.



#### **MISREPRESENTATION ACT 1967**

These particulars are issued by Haf Jones & Pegler on the understanding that: (1) the particulars are set out as a general guidance for intending purchasers or lessees and do not constitute, or constitute part of, an offer or contract; (2) all descriptions, dimensions, reference to condition and necessary permissions for use and occupation, and other details are given in good faith and are believed to be correct, but any intending purchasers or tenants should not rely on them as statements or representations of fact but must satisfy themselves by inspection or otherwise as to the correctness of each of them; (3) no person in the employment of Haf Jones & Pegler has any authority to make or give any warranty whatever in this property; (4) neither Haf Jones & Pegler nor the vendors of the property shall be responsible for any expense that may be incurred in visiting the property should it prove to be unsuitable or to have been let, sold or withdrawn. Applicants are advised to make an appointment through us before viewing.



Land Registry  
Official copy of  
title plan

Title number **CYM598629**  
Ordnance Survey map reference **SH5869SE**  
Scale **1:2500**  
Administrative area **Gwynedd**



© Crown copyright and database rights 2013 Ordnance Survey 100026316.  
You are not permitted to copy, sub-license, distribute or sell any of this data to third parties in any form.

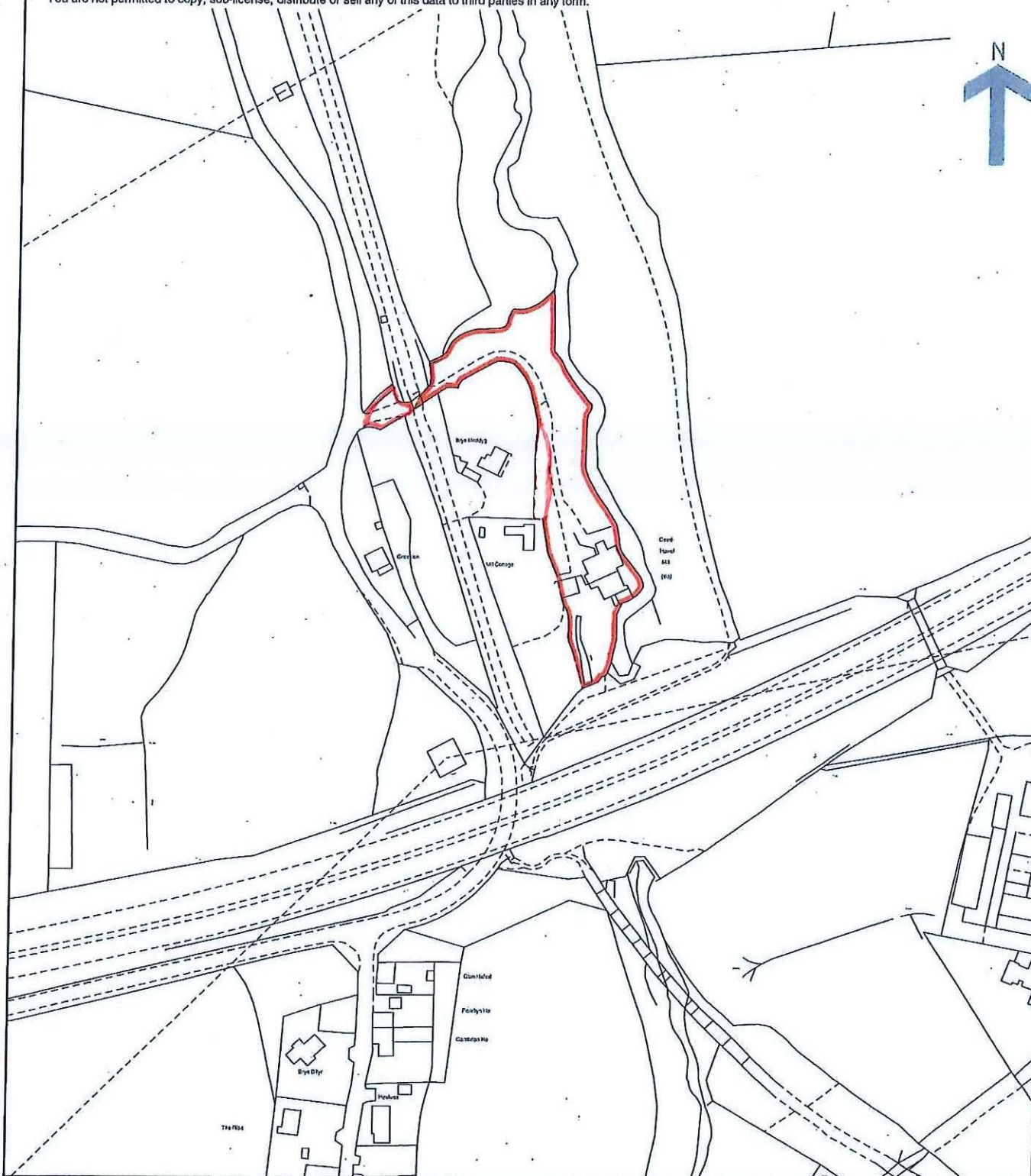

**This official copy issued on 18 November 2013 shows the state of this title plan on 18 November 2013 at 09:56:56. It is admissible in evidence to the same extent as the original (s.67 Land Registration Act 2002).**  
This title plan shows the general position, not the exact line, of the boundaries. It may be subject to distortions in scale. Measurements scaled from this plan may not match measurements between the same points on the ground. See Land Registry Public Guide 19 - Title Plans and Boundaries.  
**This title is dealt with by Land Registry, Wales Office.**

# The Old Mill, Glasinfryn

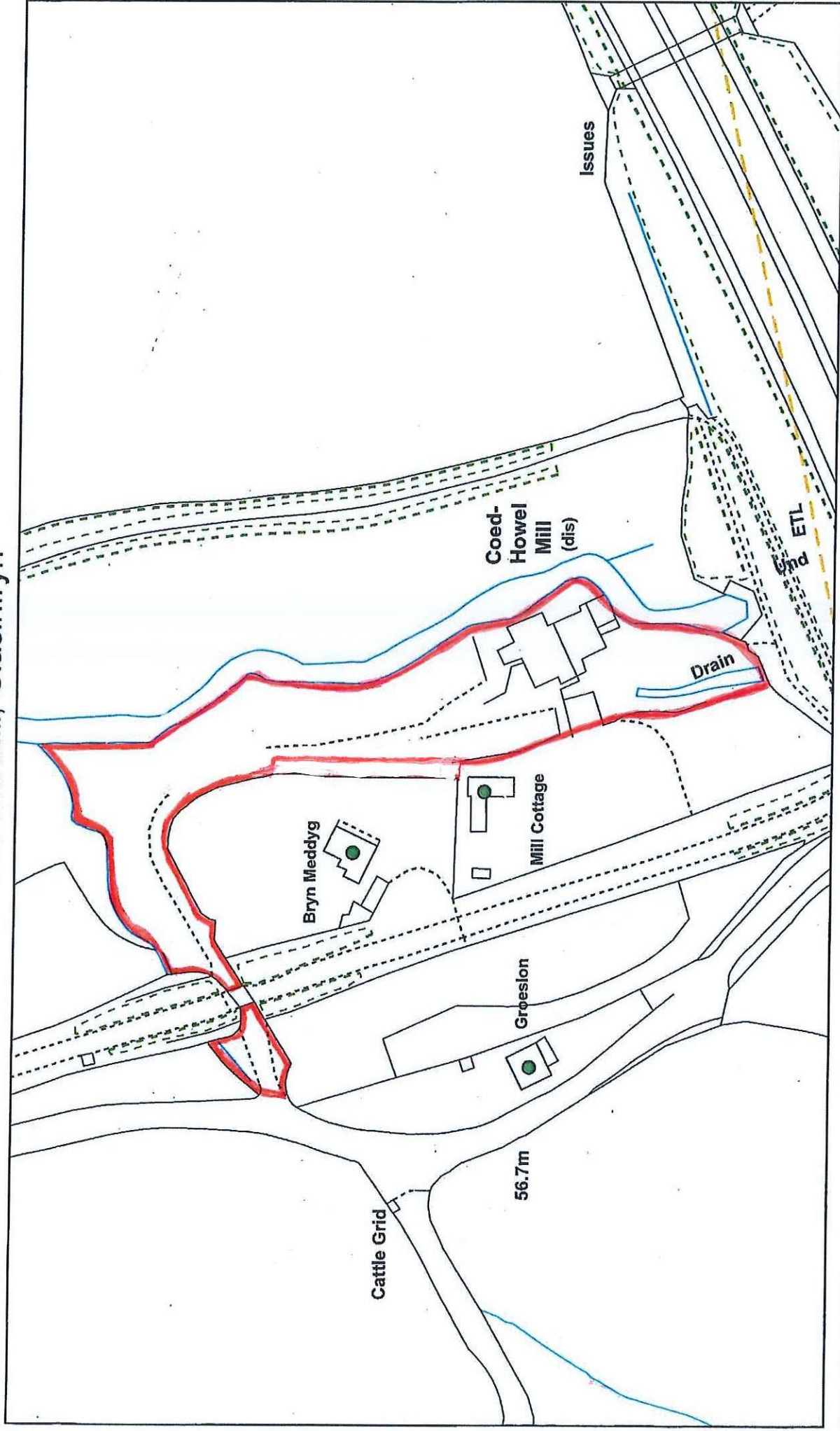

September 2, 2014

